

## Certification Body:

  
 ABN: 80 111 217 568  
 JAS-ANZ Accreditation  
 No. Z4450210AK  
 PO Box 7144, Sippy  
 Downs Qld 4556  
 +61 (07) 5445 2199  
[www.CertMark.org](http://www.CertMark.org)

## Certificate Holder:

**New Era Nominees**  
 ABN: 23 616 425 211  
 18/113 High Road  
 Willetton WA 6155  
 Ph: +61 8 9354 3144  
[www.masterwall.com.au](http://www.masterwall.com.au)

**Certificate number: CM40209**

## THIS TO CERTIFY THAT

## Masterwall® Direct-to-Frame System

### Type and/or use of product:

Non-load bearing External Insulated Façade System.

### Description of product:

The MasterWall® Direct-to-Frame System is a non-load bearing integrated façade system for external walls. The panel is available in the following core thicknesses: 50mm, 75mm, 100mm and 125mm.

## COMPLIES WITH THE FOLLOWING BCA PROVISIONS AND STATE OR TERRITORY VARIATION(S)

## BCA 2016

	Volume One (Amdt. 1)	Volume Two
<b>Performance Requirement(s)</b>		
	BP1.1(b)(iii) Wind action – Minimum panel thickness 75mm	P2.1.1(b)(iii) Wind action – Minimum panel thickness 75mm
	FP1.4 Weatherproofing – Refer A3	P2.2.2 Weatherproofing – Refer A3
	FP1.5 Dampness - Moisture from ground	P2.2.3 Dampness – Moisture from ground
	GP5.1 Construction in Bushfire areas – BAL A-29 – Refer A3	P2.3.4 Bushfire areas – BAL A-29 – Refer A3
<b>Deemed-to-Satisfy Provision(s):</b>	C1.10(a)(ii) Fire hazard properties – Wall linings – Polystyrene panel only	3.12.1.4 Energy Efficiency – Refer A3
	J1.5 Energy efficiency Walls – Refer A3	
<b>State or territory variation(s):</b>	GP5.1 NSW, Qld & Tas.	P2.3.1 Tas

## SUBJECT TO THE FOLLOWING LIMITATIONS AND CONDITIONS AND THE PRODUCT TECHNICAL DATA IN APPENDIX A AND EVALUATION STATEMENTS IN APPENDIX B

### Limitations and conditions:

- The Masterwall® Direct-to-Frame system must be designed and installed in accordance with the [Masterwall® Direct-to-Frame System Installation & Construction Details technical document dated 20/09/2018](#). Any variation from this design manual fall outside the scope of this certification.
- The MasterWall® Direct-to-Frame System comprises a number of proprietary components that are required to be installed by a licensed tradesperson as approved by New Era Nominees.
- The Masterwall® Direct-to-Frame system is not suitable for use as an FRL rated compliant system.
- The Masterwall® Direct-to-Frame system must be installed with either:
  - A timber frame constructed in accordance with AS 1684; or

### Building classification/s:

1,2,3,4,5,6,7,8,9 & 10  
 (Refer Conditions & limitation 5)

  
**John Thorpe - CMI**

  
**Don Grehan – Unrestricted Building Certifier**

**Date of issue:** 23/10/2018

**Date of expiry:** 23/10/2021



# Certificate of Conformity

- II. A cold-formed steel frame constructed in accordance with NASH Standard for Residential and Low-rise Steel Framing, Part 1: Design Criteria, or
- III. AS 3623 Domestic Metal Framing; or
- IV. Framework compliant with other standards as applicable.
- 5. This certification is applicable to Type C. (Excludes Type A or Type B Construction including Class 2, 3, and 9 buildings of 2 storeys or more and Class 4, 5, 6, 7, and 8 buildings of 3 storeys or more).
- 6. The Masterwall® Direct-to-Frame System is not suitable for use as an FRL rated compliant system in accordance with AS 1530.4 for boundary walls and/or party walls as a standalone walling system.
- 7. In the absence of a site-specific performance solution, this system is not suitable for use in or on Class 2 to 9 of Type A & B construction, where the NCC requires buildings and/or Ancillary Elements to be non-combustible.
- 8. Nothing in this document should be construed as a warranty or guarantee by CMI, and the only applicable warranties will be those provided by the Certificate Holder.
- 9. This Certificate is issued based on the evidence of compliance as detailed herein. Any deviation from the specifications contained in this Certificate is outside of this document's scope and the installation of the certified product/system will not be covered by this CodeMark certification. This may result in the product being classified as a non-conforming building product/system.

**Scope of certification:** The CodeMark Scheme is a building product certification scheme. The rules of the Scheme are available at the ABCB website [www.abcb.gov.au](http://www.abcb.gov.au). This Certificate of Conformity is to confirm that the relevant requirements of the Building Code of Australia (BCA) as claimed against have been met. The responsibility for the product performance and its fitness for the intended use remain with the certificate holder. The certification is not transferrable to a manufacturer not listed on Appendix A of this certificate.

**Disclaimer:** The Scheme Owner, Scheme Administrator and Scheme Accreditation Body do not make any representations, warranties or guarantees, and accept no legal liability whatsoever arising from or connected to, the accuracy, reliability, currency or completeness of any material contained within this certificate; and the Scheme Owner, Scheme Administrator and Scheme Accreditation Body disclaim to the extent permitted by law, all liability (including negligence) for claims of losses, expenses, damages and costs arising as a result of the use of the product(s) referred to in this certificate.

## APPENDIX A – PRODUCT TECHNICAL DATA

### A1 Type and intended use of product

As per page one.

### A2 Description of product

MasterWall® Direct-To-Frame System is an external lightweight, reinforced, insulating wall panel, mechanically fixed to the outer face of the wall framing. The base material is a grey coloured Medium (M) Grade fire retardant expanded polystyrene (EPS) with a fibreglass mesh reinforced “MasterWall®” branded cementitious-based facing compatible with approved acrylic render and decorative finishes.

Mesh jointing tape is applied at all panel joins and at 45 degrees to the corners of all openings. MasterWall® Breather Wrap, Premium Quality Modified Liquid Sealant, Alloy-Mesh Reinforced External Corner Trims, Polyurethane Foam Sealant, MasterWall® Self Adhering Flashing Tape and decorative and waterproof coatings are integral to the performance of the system.

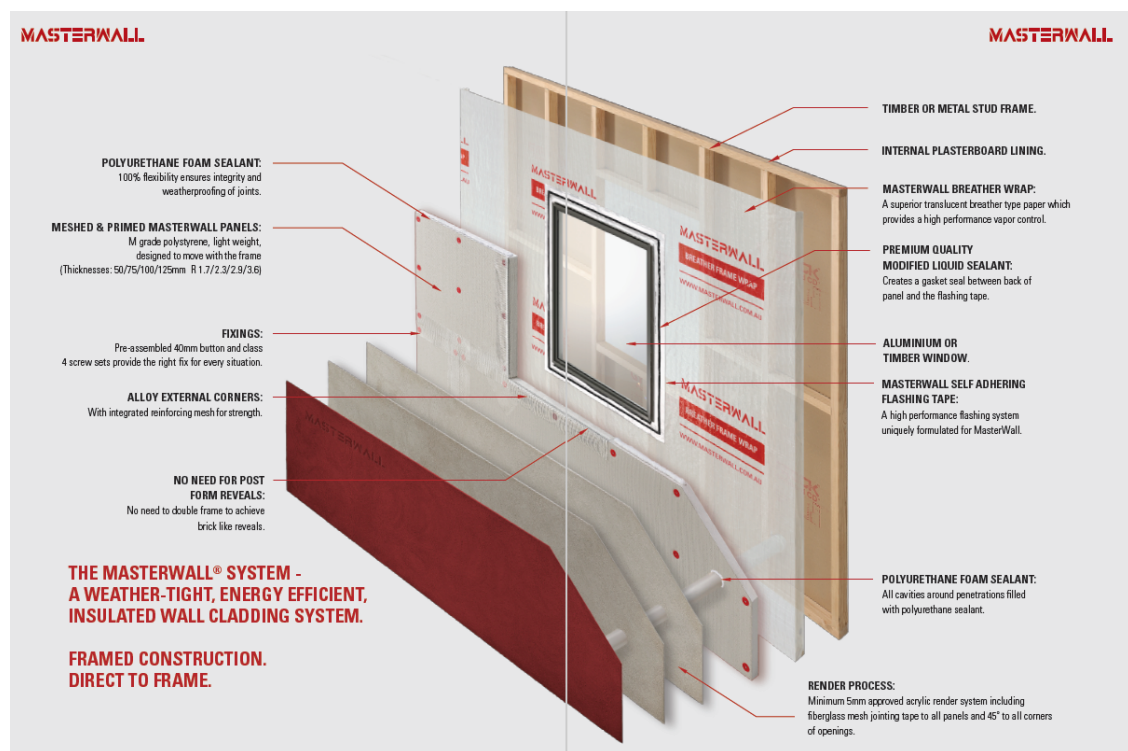

*Image Source: Masterwall® Direct-to-Frame System Installation & Construction Details technical document dated 20/09/2018.*

### A3 Product specification

# Certificate of Conformity

## Fire:

When tested in accordance with AS/NZS 1530.3-1999, the Polystyrene panel has been found to comply with Specification C1.10-7, Spread-of-Flame & Smoke-Developed Indices to AS/NZS 1530.3-1999 (where the tested performance is shown to be Spread of Flame Index = 0, Smoke Developed Index = 4).

## Structure:

The strength of the MasterWall® Direct-To-Frame System is limited to Design Ultimate Limit State Wind Pressures:

1. non-cyclonic - calculated in accordance with AS/NZS 1170.2:2011(2016) Structural Design Actions Part 2: Wind Actions, of +2.01 kPa and -3.01 kPa. This includes AS 4055-2012 Wind Classifications N1, N2, N3 and N4 and excludes AS 4055-2012 Wind Classifications N4, N5, N6; and
2. cyclonic - calculated in accordance with AS/NZS 1170.2:2011(R2016) Structural Design Actions Part 2: Wind Actions, of +2.68 kPa and -4.02 kPa where the minimum panel thickness is 75mm and the maximum stud spacing is 450mm. This includes AS 4055-2012 Wind Classifications C1 & C2 and excludes AS 4055-2012 Wind Classifications C3 & C4.

## Weatherproofing:

Limited to external wall applications where the design serviceability limit state wind pressure, calculated in accordance with AS/NZS 1170.2:2011(R2016) Structural Design Actions Part 2: Wind Actions, does not exceed +0.82 kPa and -1.23 kPa. This is deemed to include AS 4055-2012 Wind Classifications N1, N2, N3, N4, C1 & C2 (and excludes AS 4055-2012 Wind Classifications, N5, N6, C3 & C4).

## Damp Proofing of External Walls:

When installed in accordance with the Masterwall® Direct-to-Frame System Installation & Construction Details technical document dated 20/09/2018, the system meets the requirements for FP1.5 & P2.2.3.

## Bushfire:

The MasterWall® Direct-To-Frame System is considered to achieve a bushfire resistance performance of BAL - A-29 when incorporating:

- render system with minimum thickness 6.5mm, and
- EPS thicknesses of 75mm or 100mm, and
- 160gsm fiberglass mesh, and
- other components identified in Report Exova Warringtonfire Report FAS 180357.3 Section 2, dated 01/10/2018 (available from the Certificate Holder upon request).

## Thermal:

MasterWall® panel, breather wrap, stud frame cavity and 10mm plasterboard when tested in accordance with AS/NZS 4859.1:2002 achieve the following thermal values:

Thickness	Rating	Rt*
50mm	1.3	1.7
75mm	2.0	2.3
100mm	2.7	2.9
125mm	3.3	3.6

**Source:** Acronem Consulting Pty Ltd Appraisal ACA 180929; Dated 16/10/2018.



# Certificate of Conformity

## A4 Manufacturer and manufacturing plant(s)

New Era Nominees  
18/113 High Road,  
Willetton WA 6155.

## A5 Installation requirements

The Masterwall® Direct-to-Frame System must be installed in accordance with the [Masterwall® Direct-to-Frame System Installation & Construction Details technical document dated 20/09/2018](#).

## A6 Other relevant technical data

No other relevant technical data.

## APPENDIX B – EVALUATION STATEMENTS

### B1 Evaluation methods

CMI has followed the following procedures for certifying the Masterwall® Direct-to-Frame System:

- Testing and assessment of the Masterwall® Direct-to-Frame System;
- Assessing a quality plan for the Masterwall® Direct-to-Frame System that conforms to ISO 10005 and the CodeMark scheme rules;
- By reviewing testing of samples supplied to ascertain whether or not the product meets the performance requirements specified on this certificate; and
- Conducting site audits of the factory to verify compliance of the Masterwall® Direct-to-Frame System.

### B2 Reports

- a. Acronem Consulting Pty Ltd; Appraisal No. ACA 180929; Technical engineering appraisal; Dated 16/10/2018.
- b. Acronem Consulting Pty Ltd; Certificate of Compliance; Dated 20/08/2018.
- c. Exova Warringtonfire; Report FAS 180357.3; Testing of Polystyrene panel in accordance with AS/NZS 1530.3-1999, dated 01/10/2018.

The Certificate Holder has chosen not to make the above evidence of compliance publicly available, due to the documents being considered commercial in confidence.